



Standalone module ML 2 MSR and OCR reader



Description

This device contains two independent readers: The OCR modul for machine readable documents (e.g. ID cards, passports) and a magnetic card reader for recording credit cards or access cards. The ergonomic design has been selected to achieve optimum adaptation to human work movement.

Both internal readers operate bidirectionally, so that documents and cards can be fed through the reader in both directions. This means that the input device is ergonomic and easy-to-use for both right and left-handed users.

The option to install this device flush-mounted into the user's furniture fittings completes the outstanding ergonomic design.

For all applications which require clear, rapid recording of machine-readable data from documents, this module offers a practical and cost-effective solution.

Features

- 3-track magnetic stripe reader
- OCR reader (OCR-B; other fonts available on request)
- Status indicator for good/bad reading
- Buzzer for acoustic feedback

PrehKeyTec GmbH is a leading international manufacturer of high-quality data input systems. Products include modular standard keyboards which are particularly suitable for professional use due to their high level of flexibility and extreme reliability.

ML 2 Technical Data

Standalone module

- Power supply via USB 5V+ 5%
- Power consumption < 500 mA
- USB interface

OCR reader

- Control via virtual COM interface or PC keyboard wedge (keyboard wedge hardware available from 12/09)
- Bidirectional document feed
- Reads machine-readable travel documents that comply with ICAO9303
- Reads OCR-B data from machine-readable passports with 2 lines and maximum of 44 characters (OCR A data on request)
- Reads machine-readable visas with 2 lines and max. 44 characters or 2 lines with 36 characters
- Reads machine-readable travel documents with 2 lines and 36 characters, or 3 lines and 30 characters
- Reads bank checks, MICR E13B encoded according to ISO 1004
- Other machine-readable data on request
- Software update via USB interface
- Buzzer (from 12/09)

Magnetic card reader

- Card can be swiped in both directions
- Reads track 1, 2 and 3 in accordance with ISO 7810, ISO 7811
- Additional configuration: AAMVA, CADL
- Parameters can be adjusted using WinProgrammer (header and terminator)
- Magnetic head can perform over 500,000 read cycles
- OPOS and Java POS drivers
- Status indicator for good/bad reading
- Buzzer

Radio interference

The device complies with the permitted limit values of the following standards with regard to radio interference.

1. EN 55022
2. DIN EN 61000-4-2 (15 kV air discharge, 8 kV contact discharge)
3. DIN EN 61000-4-3 (10 V/m)
4. DIN EN 61000-4-8
5. FCC part 15, limit class A

Environmental conditions

Operating temperature range: 5°C to 40°C
 Storage temperature range: -40°C to 60°C
 Rel. operational humidity: 40% to 90% RH

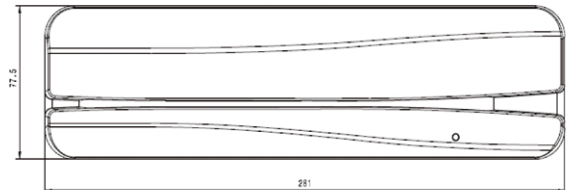
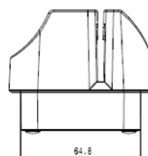
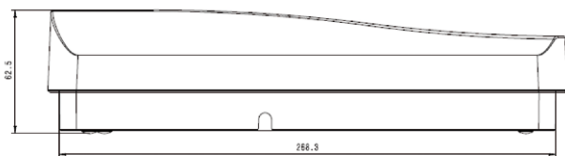

Subject to alterations 10/09 HP